

STRAIGHT PRINTED CIRCUIT BOARD JACK RECEPTACLE - THROUGH-HOLE MOUNT

FIG.	POL. (Z)	CABLE GROUP	MATERIAL	BODY PLATING	CONTACT PLATING	MOUNTING	DIM "A"	DIM "B"	DIM "C"	PART NUMBER
1	-	-	S. STEEL	GOLD	GOLD - C	PC060	.395 [10.0]	-	.155 [3.9]	39F-1PC-000-00G
1	-	-	BRASS	GOLD	GOLD - C	PC060	.395 [10.0]	-	.155 [3.9]	40F-1PC-000-00G

FIG. 1

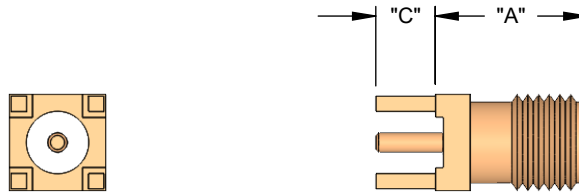

RIGHT ANGLE PRINTED CIRCUIT BOARD JACK RECEPTACLE - THROUGH-HOLE MOUNT

FIG.	POL. (Z)	CABLE GROUP	MATERIAL	BODY PLATING	CONTACT PLATING	MOUNTING	DIM "A"	DIM "B"	DIM "C"	INTELLICONNECT PART NUMBER
2	-	-	S. STEEL	GOLD	GOLD - C	PC060	.590 [15.0]	.395 [10.0]	.155 [3.9]	39F-2PC-000-00G
2	-	-	BRASS	GOLD	GOLD - C	PC060	.590 [15.0]	.395 [10.0]	.155 [3.9]	40F-2PC-000-01G
2	-	-	BRASS	GOLD	GOLD - C	PC060	.571 [14.50]	.375 [9.53]	.140 [3.56]	40F-2PC-000-04G

FIG. 2

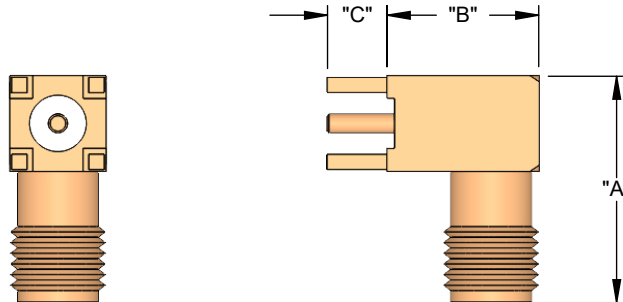

STRAIGHT PRINTED CIRCUIT BOARD JACK RECEPTACLE - SURFACE MOUNT

FIG.	POL. (Z)	CABLE GROUP	MATERIAL	BODY PLATING	CONTACT PLATING	MOUNTING	DIM "A"	DIM "B"	DIM "C"	PART NUMBER
3	-	-	S. STEEL	GOLD	GOLD - C	SF050	.395 [10.0]	-	-	39F-1SF-000-00G
3	-	-	BRASS	GOLD	GOLD - C	SF050	.395 [10.0]	-	-	40F-1SF-000-00G

FIG. 3



NOTES: 1. "C" CODING IN THE "CONTACT PLATING" COLUMN DESIGNATES A CAPTIVE CONTACT DESIGN.