

## GENERAL DESCRIPTION

This miniature connector series is designed to be compatible with the small semi-rigid and flexible cables such as RG316, RG174 and RG196. In addition, other connectors in the series can accommodate PCB, surface, edge and bulkhead configurations. This series is designed with a snap on mechanism. They are mated and unmated by a straight pull which makes them useful in areas that are inaccessible to normal mating action. The plugs have female contacts while the jacks have male contacts.

## MATERIALS

Bodies & Other Parts: Brass per ASTM B16 or equivalent.  
Female Contacts: Beryllium Copper per ASTM B196 or equivalent.  
Male Contacts: Brass per ASTM B16 or equivalent.  
Insulators (Dielectric): PTFE Fluorocarbon per ASTM D1710 or equivalent.

## ELECTRICAL

Impedance: 50 Ohms Nominal  
Frequency Range: DC-4 GHz  
Insulation Resistance: 1,000 Megohms min.  
Voltage Rating: 335 VRMS  
Dielectric Withstanding: 750 VRMS at sea level  
Voltage Standing Wave Ratio (VSWR): 1.30 +.04 (f) GHz max.  
Contact Resistance:  
    Outer Contact: 1.0 Milliohms  
    Center Contact: 6.0 Milliohms

## ENVIRONMENTAL

Temperature rating: -65°C to +165°C  
Vibration: MIL-STD-202, Method 204  
Shock: MIL-STD-202, Method 213  
Thermal Shock: MIL-STD-202, Method 107  
Corrosion (Salt Spray): MIL-STD-202, Method 101  
Moisture Resistance: MIL-STD-202, Method 106

## PLATING OPTIONS

Gold: Per MIL-G-45204, Type II, Grade C  
Nickel: Per QQ-N-290, Class II  
Silver: Per QQ-S-365, Type II, Grade A

## MECHANICAL

Force to Engage: 14 lbs. max.  
Force to Disengage: 2 lbs. min.  
Mating Cycles: 500 min.

## DESIGN IN ACCORDANCE WITH

US MIL-PRF-39012, MIL-STD-348  
CECC: 22 130  
IEC: 169-10  
BE: ES101, ES103

### JACK INTERFACE

(MALE CONTACT)

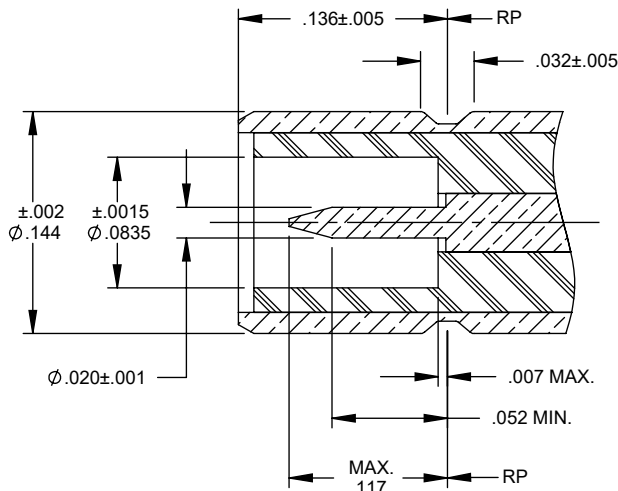
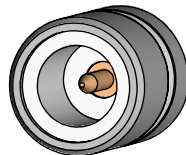

### PLUG INTERFACE

(FEMALE CONTACT)

